

Image

Terminal Type

NOT AVAILABLE

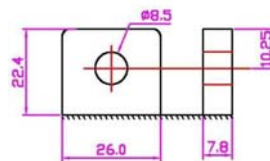

Dimensions

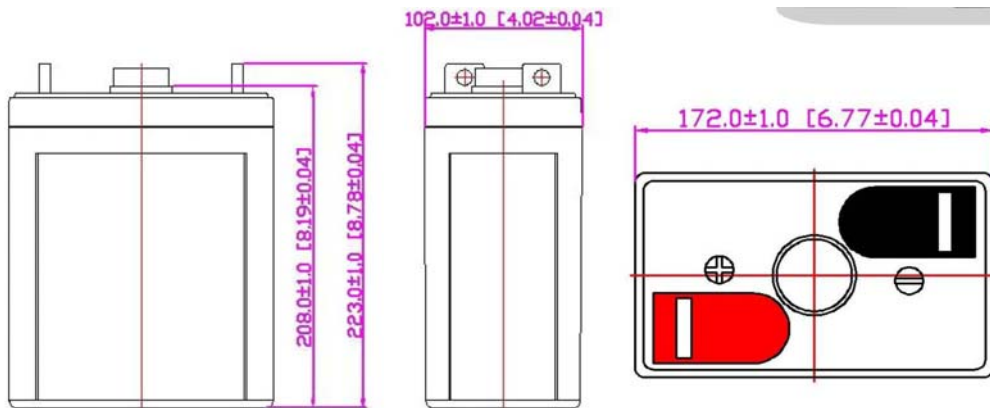

Specifications

Battery model	HL2-150			
Nominal voltage	2V			
Designed Floating Life	Up to 15 years			
Cycle use	1. Up to 260 cycles at 100% DOD		2. Up to 1200 cycles at 30% DOD	
Capacity (25°C)	10hr (15.0A, 10.8V)	5hr (24.99A, 10.8V)	3hr (36.99A, 10.8V)	1hr (78.99A, 10.8V)
	150.0Ah	124.5Ah	110.7Ah	78.99Ah
Dimensions (approx.)	Length	Width	Height	Total Height
	172mm (6.77inch)	102mm (4.02inch)	208mm (8.19inch)	223mm (8.78inch)
Approx. Weight	8.60Kg ±5% (18.96lbs)			
Internal Resistance (approx.)	Full charged at 25°C: ≤ 2.0mΩ			
Self Discharge	2% of capacity declined per month at 25°C			
Capacity Affected by Temperature	40°C	25°C	0°C	-15°C
	102%	100%	85%	65%
Charge Voltage (25°C)	Cycle Use		Float Use	
	2.40-2.50V (-5mV/°C) , max. current: 37.5A		2.25-2.30V (-3.0mV/°C)	

HL series

HL Series Valve Regulated Lead Acid batteries are designed with AGM (Absorbent Glass Mat) technology, high performance plates and electrolyte to gain extra power output for common power backup system applications.

Application

**Telecommunications
UPS
Control Equipment
Security system**

**Communication power supply
Electric Power System (EPS)
Power Plant
Medical Equipment**

**Cable Television
Backup power supply
DC power supply
Auto control system**

Construction

**Component: Raw material
Positive: Lead dioxide
Negative: Lead
Container: ABS (UL94HB) (FR-UL94V0 optional)
Cover: ABS (UL94HB) (FR-UL94V0 optional)**

**Sealant: Epoxy Resin
Safety Valve: EPDR (Rubber)
Terminal: Copper
Separator: Fibre Glass
Electrolyte: Sulphuric acid**

*Sealed and maintenance free Non-spillable construction design Low self discharge characteristic
Unique grid alloy formula and updated manufacturing technique*



ACU ESPAÑA, S.L.
E-mail: comercial@acu.es
Web: www.acu.es
P.I. "Els Garrofers" - Avda. Progrés,5 - 08340 Vilassar de Mar - Barcelona - SPAIN

Telf: +34 93 754 09 60

Fax: 902 550 436

Terminal Voltage (V) and Discharge Time

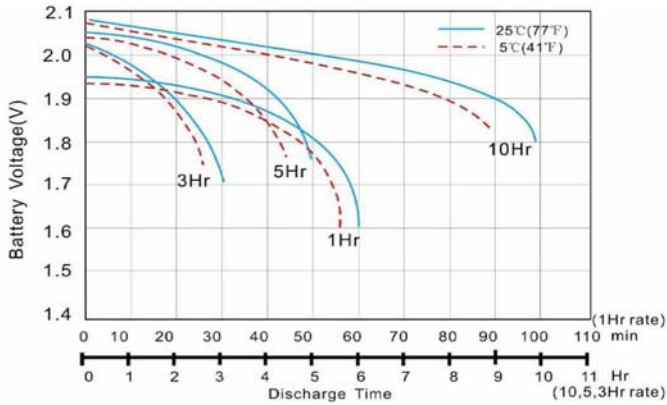

Capacity Retention Characteristic

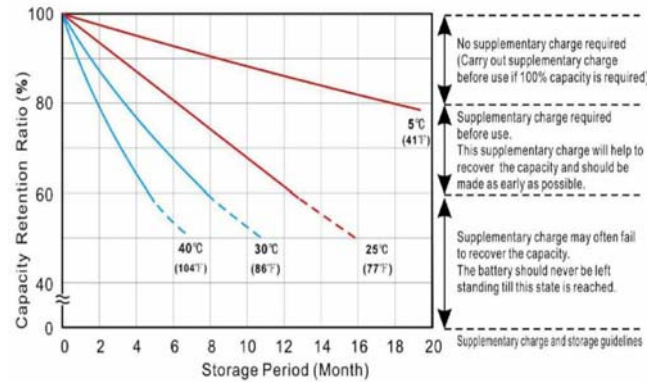

Battery Voltage and Charge Time for Standby Use

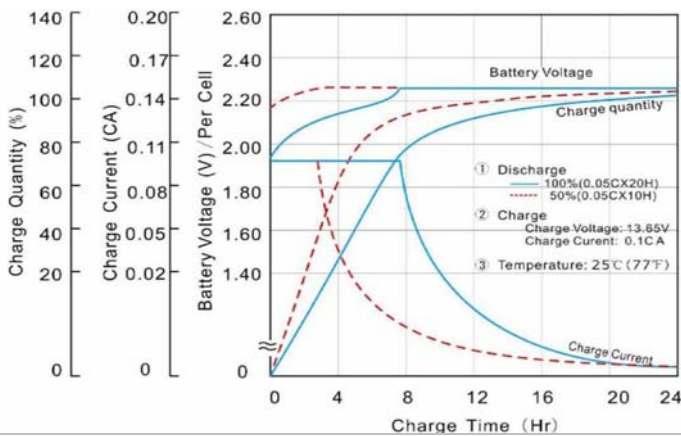

Trickle (or Float) Service Life

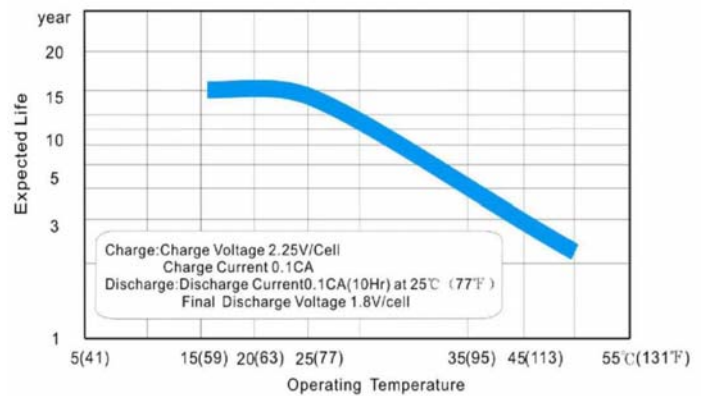

Constant Current Discharge Ratings per monoblock – Amperes at 25°C (77°F)

F.V / Time	10min.	15min	30min	1h	3h	5h	8h	10h	20h
1.67V/c	437.18	279.31	136.16	87.77	38.50	26.01	18.63	15.61	7.99
1.70V/c	397.11	257.45	125.51	83.13	38.09	25.73	18.43	15.45	7.91
1.75V/c	364.32	242.88	118.40	79.94	37.43	25.29	18.11	15.18	7.77
1.80V/c	360.00	240.00	117.00	78.99	36.99	24.99	17.90	15.00	7.68
1.85V/c	350.91	233.94	114.05	77.00	36.06	24.36	17.44	14.62	7.49

Constant Current Discharge Ratings per cell – Watts/cell at 25°C (77°F)

F.V / Time	10min	15min	30min	1h	3h	5h	8h	10h	20h
1.67V/c	852.5	544.7	265.5	171.2	75.1	50.7	36.3	30.4	15.6
1.70V/c	774.4	502.0	244.7	162.1	74.3	50.2	35.9	30.1	15.4
1.75V/c	710.4	473.6	230.9	155.9	73.0	49.3	35.3	29.6	15.2
1.80V/c	702.0	468.0	228.2	154.0	72.1	48.7	34.9	29.3	15.0
1.85V/c	684.3	456.2	222.4	150.1	70.3	47.5	34.0	28.5	14.6

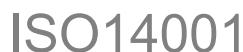

Ratings and features presented herein are subject to revision without notice



ACU ESPAÑA, S.L. Telf: +34 93 754 09 60 Fax: 902 550 436
 E-mail: comercial@acu.es
 Web: www.acu.es
 P.I. "Els Garrofers" - Avda. Progrés,5 – 08340 Vilassar de Mar – Barcelona - SPAIN