

Image

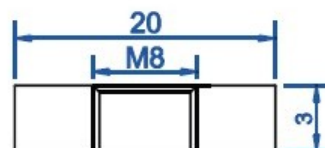

Terminal Type



M8 Bolt

Dimensions

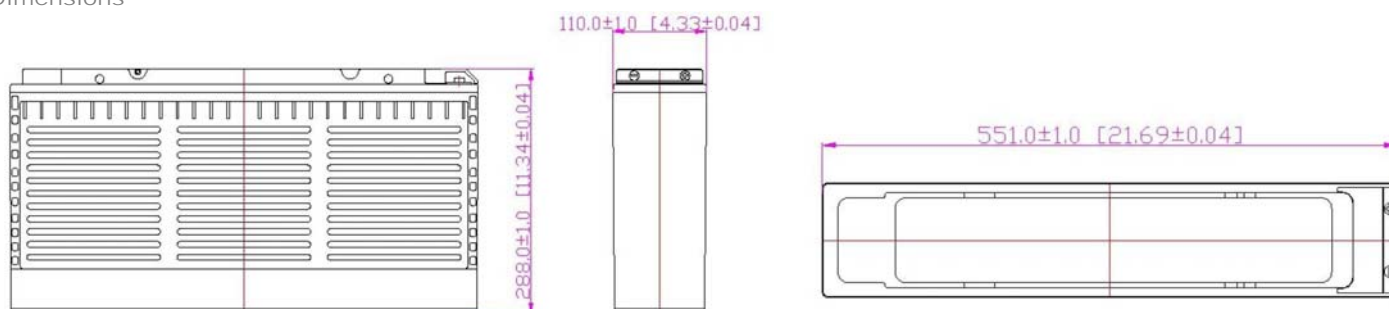

Specifications

| | | | | |
|----------------------------------|--|----------------------|--------------------------------|----------------------|
| Battery model | HL12-155R | | | |
| Nominal voltage | 12V | | | |
| Designed Floating Life | Up to 10 years | | | |
| Cycle use | 1. Up to 260 cycles at 100% DOD | | 2. Up to 500 cycles at 50% DOD | |
| Capacity (25°C) | 20hr (8.06A, 10.8V) | 10hr (15.50A, 10.8V) | 5hr (28.39A, 10.5V) | 1hr (94.59 A, 10.5V) |
| | 161.20Ah | 155.00Ah | 141.95Ah | 94.59Ah |
| Dimensions (approx.) | Length | Width | Height | Total Height |
| | 551mm (21.69inch) | 110mm (4.33inch) | 288mm (11.34inch) | 288mm (11.34inch) |
| Approx. Weight | 48.0Kg ±5% (105.84lbs) | | | |
| Internal Resistance (approx.) | Full charged at 25°C: ≤ 4.0mΩ | | | |
| Self Discharge | 2% of capacity declined per month at 25°C | | | |
| Capacity Affected by Temperature | 40°C | 25°C | 0°C | -15°C |
| | 102% | 100% | 85% | 65% |
| Charge Voltage (25°C) | Cycle Use | | Float Use | |
| | 14.40-14.60V (-30mV/°C) , max. current: 38.75A | | 13.60-13.80V (-20mV/°C) | |

HL-R series

HL-R Series Valve Regulated Lead Acid batteries are designed with AGM (Absorbent Glass Mat) technology, front terminal, high performance plates and electrolyte to gain extra power output for common power backup system applications.

Application

| | | |
|---------------------------|------------------------------------|----------------------------|
| Telecommunications | Communication power supply | Cable Television |
| UPS | Electric Power System (EPS) | Backup power supply |
| Control Equipment | Power Plant | DC power supply |
| Security system | Medical Equipment | Auto control system |

Construction

| | | | |
|-------------------|--|----------------------|-----------------------|
| Component: | Raw material | Sealant: | Epoxy Resin |
| Positive: | Lead dioxide | Safety Valve: | EPDR (Rubber) |
| Negative: | Lead | Terminal: | Copper |
| Container: | ABS (UL94HB) (FR-UL94V0 optional) | Separator: | Fibre Glass |
| Cover: | ABS (UL94HB) (FR-UL94V0 optional) | Electrolyte: | Sulphuric acid |

*Sealed and maintenance free Non-spillable construction design Low self discharge characteristic
Unique grid alloy formula and updated manufacturing technique*

Charge Characteristic for Standby Use

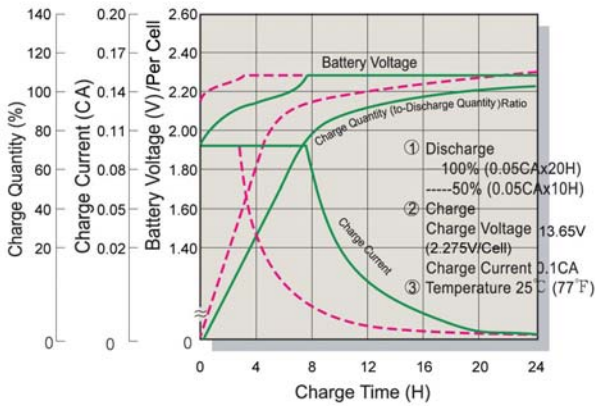

Discharge Characteristic 25°C / 20°C

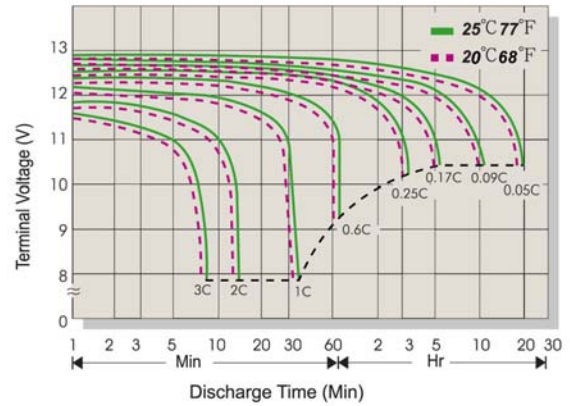

Tickle (or Float) Service Life

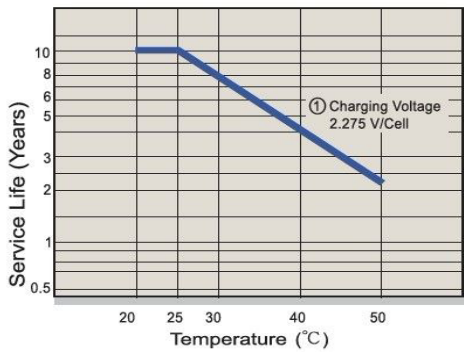

Self Discharge Characteristics

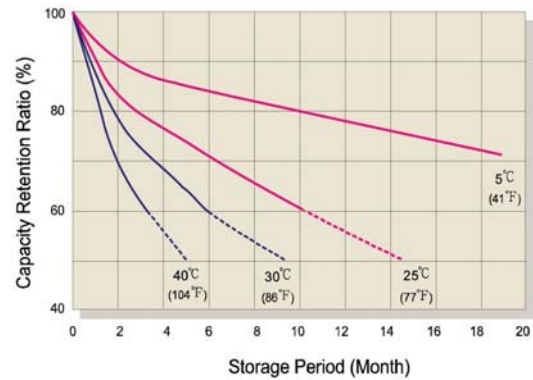

Constant Current Discharge Ratings per monoblock - Amperes at 25°C (77°F)

| F.V / Time | | 10min | 15min | 30min | 1h | 3h | 5h | 10h | 20h |
|------------|----|--------|--------|--------|--------|-------|-------|-------|------|
| 1.67V/c | -- | 470.58 | 250.74 | 176.78 | 103.86 | 43.56 | 29.20 | 16.13 | 8.39 |
| 1.70V/c | -- | 427.44 | 231.12 | 162.95 | 98.36 | 43.10 | 28.89 | 15.96 | 8.30 |
| 1.75V/c | -- | 392.15 | 218.04 | 153.72 | 94.59 | 42.35 | 28.39 | 15.69 | 8.16 |
| 1.80V/c | -- | 387.50 | 215.45 | 151.90 | 93.47 | 41.85 | 28.06 | 15.50 | 8.06 |
| 1.85V/c | -- | 377.72 | 210.01 | 148.07 | 91.11 | 40.79 | 27.35 | 15.11 | 7.86 |

Constant Current Discharge Ratings per cell - Watts/cell at 25°C (77°F)

| F.V / Time | | 10min | 15min | 30min | 1h | 3h | 5h | 10h | 20h |
|------------|----|-------|-------|-------|-------|------|------|------|------|
| 1.67V/c | -- | 917.6 | 488.9 | 344.7 | 202.5 | 84.9 | 56.9 | 31.5 | 16.4 |
| 1.70V/c | -- | 833.5 | 450.7 | 317.7 | 191.8 | 84.0 | 56.3 | 31.1 | 16.2 |
| 1.75V/c | -- | 764.7 | 425.2 | 299.8 | 184.4 | 82.6 | 55.4 | 30.6 | 15.9 |
| 1.80V/c | -- | 755.6 | 420.1 | 296.2 | 182.3 | 81.6 | 54.7 | 30.2 | 15.7 |
| 1.85V/c | -- | 736.6 | 409.5 | 288.7 | 177.7 | 79.5 | 53.3 | 29.5 | 15.3 |



Ratings and features presented herein are subject to revision without notice



ACU ESPAÑA, S.L. Telf: +34 93 754 09 60 Fax: 902 550 436
 E-mail: comercial@acu.es
 Web: www.acu.es
 P.I. "Els Garrofers" - Avda. Progrés,5 - 08340 Vilassar de Mar - Barcelona - SPAIN